

Parking, delivery routes and elevators to the Event halls in the Vienna City Hall

The access points Felderstraße 1 A and Friedrich Schmidt Platz 1 are open on weekdays Mon.-Fri. from 07:00-18:00 and the access point Lichtenfelsgasse 2 from 06:00 to 20:00. On weekends, holidays and outside the weekday opening hours, access (or chip collection) is only possible via Lichtenfelsgasse 2. In front of the gate on the right there is a bell to register with the guard city hall.



There are existing loading zones in Lichtenfelsgasse and Felderstraße.

It is also possible to apply in front of the Felderstraße 1 B gate, in a timely manner to MA 46, for approval of a demand-based stopping and parking ban "except for vehicles with trolley cards".

Access via Felderstraße 1 B to the elevator Stiege 6:

- .) An access chip must be collected from the City Hall security guard, Feststiege 1, ground floor, which can be used to operate the sliding glass door.
- .) The organizer has to assign a person to supervise the access and deliveries.
- .) It is forbidden to keep the glass door open by means of bearings ect. If the glass door is open for more than two minutes, an alarm will be triggered.
- .) Access from the sidewalk to the elevator is barrier-free

- .) The dimensions of the elevator No. 6: entrance height 128 cm, entrance height 220 cm.
The internal dimensions are 250 cm long, 220 cm high and 150 cm wide.
The load capacity is 2000 kg.
- .) The ballrooms are located on the 1st floor

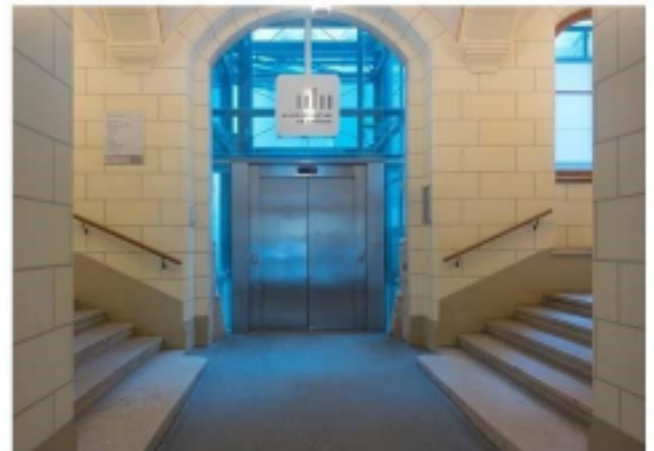

Access to the freight elevator 10 via Felderstraße 1 and Lichtenfelsgasse 2, via the arcade courtyard:



- .) Access is barrier-free
- .) The dimensions of the freight elevator No. 10: entrance width 132 cm, entrance height 210 cm.
- .) The internal dimensions are 300 cm long, 230 cm high and 195 cm wide.
- .) The load capacity is 3000 kg.

What is there to consider with elevators:

- .) The organizer must assign a supervisor to monitor the deliveries and the loading process.
- .) Deliveries destined for the banquet hall must pass through the aisle area and may not pass through the coat of arms hall group. (Shown with a red line on the general plan.) .) In the case of elevators, care must be taken to ensure that the loading switch is activated during loading so that the sliding doors are not damaged.
- .) Verifiable damage will be charged to the organizer.

OVERVIEW MAP

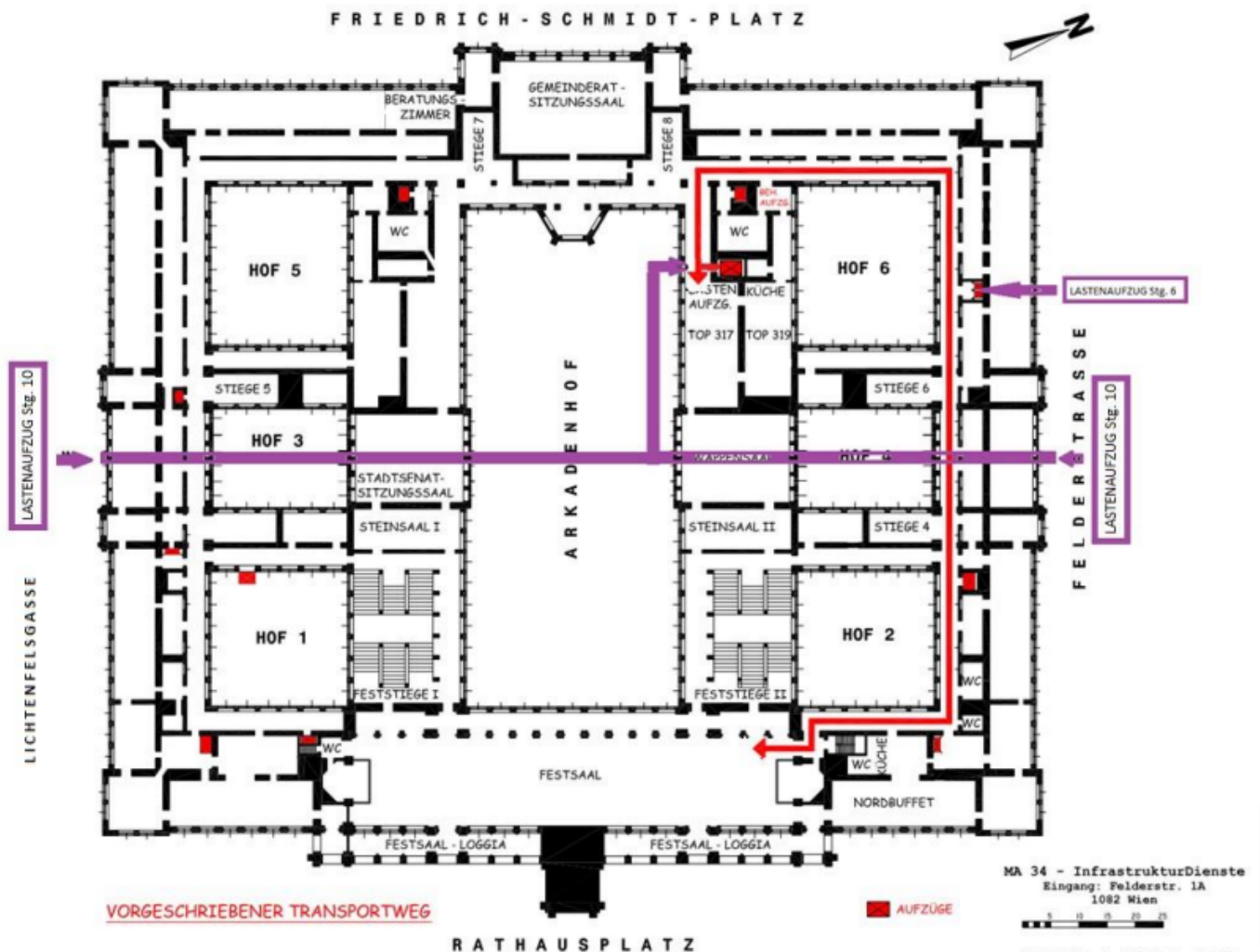

The entry for vehicles into the Vienna City Hall is only allowed with AUTHORIZATION. Max. vehicle width 235 cm / max. vehicle height 355 cm

Parking

There are 3 underground parking options available:

- BOE Garage Rathauspark: <http://www.boe-parking.at/>
- Felderstraße 4 Parking: Felderstraße 4, 1010 Wien
- Tiefgarage Rathausquartier - Wien | APCOA:
<https://www.apcoa.at/parken/wien/rathausquartier-wien-apcoa/>

Most parts of Vienna are short-term parking zones for which you require a prepaid parking voucher. As these vouchers have a max. duration of two hours - we recommend to use one of the parking options above.